

# PROGLOW FITTING INSTRUCTIONS

For use with mono-filament lines between 1.2mm - 2.4mm in diameter.

## Fitting to a new line

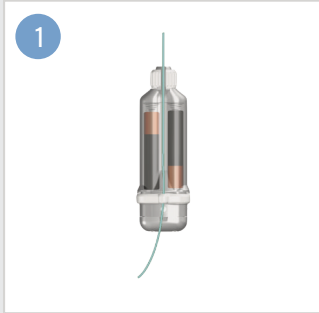

Feed the end of the line through the notch in the line clip and up through the groove in the locking collar.

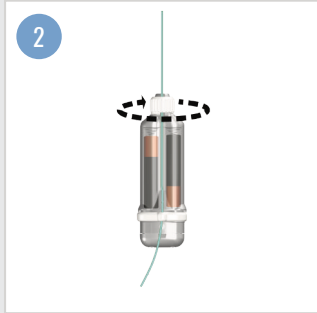

Twist the locking collar clockwise until it clicks, making sure the line is trapped inside.

## Retrofitting

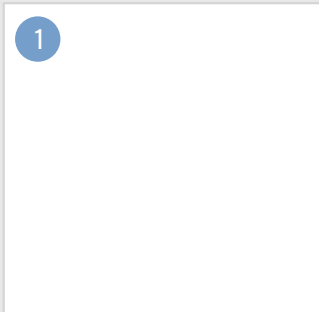

Remove the line clip completely.

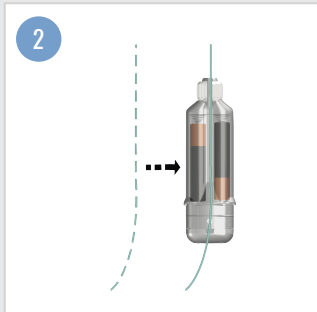

Fit the line through the locking collar.

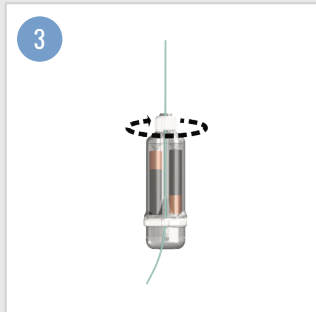

Twist the locking collar clockwise until it clicks, making sure the line is trapped inside.

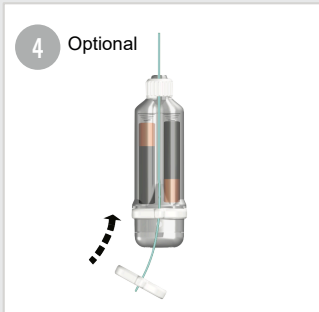

Replace the line clip by looping it over the existing hook and crimp, and snap it onto the bottom of the light

# TECHNICAL SPECIFICATIONS

|                     |   |
|---------------------|---|
| Dimensions          | 92mm x 27mm x 16mm                        |
| Weight out of water | 41 grams                                  |
| In-water weight     | 17 grams                                  |
| Depth Rating        | 1000m                                     |
| Attachment          | Dual point attachment with locking collar |
| Battery Type        | 2 replaceable AAA batteries               |
| Immersion Switch    | Automatic immersion switch                |
| Housing             | Durable polycarbonate                     |

## Proglow model variations

### BRIGHT

|                 |   |
|-----------------|---|
| Battery Life    | 5000 Hours (3 Years fishing)                        |
| Colour Options  | Green or white (other colours available on request) |
| Light Intensity | Equivalent to one 4inch lightstick (0.07lumen)      |

### SUPERBRIGHT

|                 |   |
|-----------------|---|
| Battery Life    | 1700 Hours (1 Year fishing)                         |
| Colour Options  | Green or white (other colours available on request) |
| Light Intensity | Equivalent to three 4 inch light stick (0.21lumen)  |



+44 (0) 1803 849 311  
info@fishtekmarine.com  
www.fishtekmarine.com

Fishtek Marine, Unit 1, Webbers Way  
Dartington, Totnes, Devon, TQ9 6JY