



# PROGLOW

Advanced long-line fishing light

DURABLE • EFFECTIVE • LOW COST • REPLACEABLE BATTERIES

## BRIGHTNESS STRENGTHS:

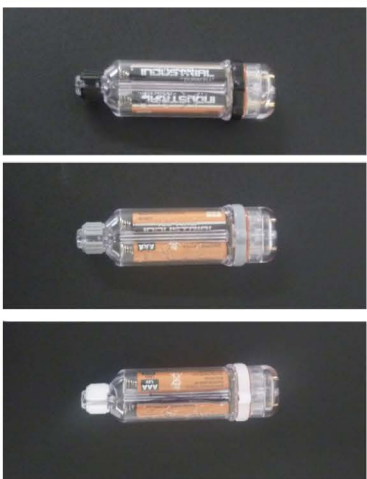

- **BRIGHT (5000 HOURS)**  
3 YEARS FISHING:  
EQUIVALENT BRIGHTNESS OF 1 LIGHTSTICK
- **SUPERBRIGHT (1600 HOURS)**  
1 YEARS FISHING:  
EQUIVALENT BRIGHTNESS OF 3 LIGHTSTICKS
- **ULTRABRIGHT (500 HOURS)**  
4 MONTHS FISHING:  
EQUIVALENT BRIGHTNESS OF 9 LIGHTSTICKS

## COLOURS:

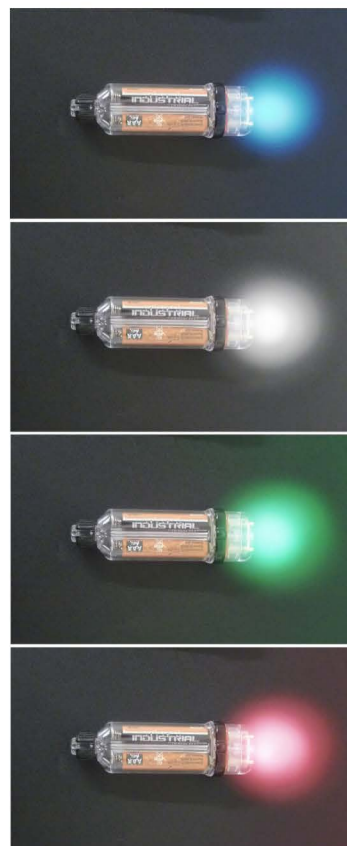

- BLUE
- WHITE
- GREEN
- RED

## LINE ATTACHMENT TYPES:

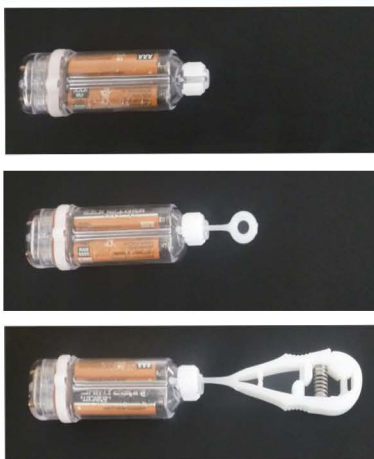

- **STANDARD LOCKING COLLAR**  
FITS 1.2 – 2.4 MM LINE DIAMETER
- **EYE**  
FOR ATTATCHING YOUR OWN SNAPS
- **SNAP**  
FITS 1.2 – 3MM LINE DIAMETER

www.fishtekmarine.com  
+44 (0) 1803 225253  
info@fishtekmarine.com

# PROGLOW FITTING INSTRUCTIONS

## Attaching using the locking collar

For locking collar use with mono-filament lines between 1.2 mm - 2.4 mm in diameter.

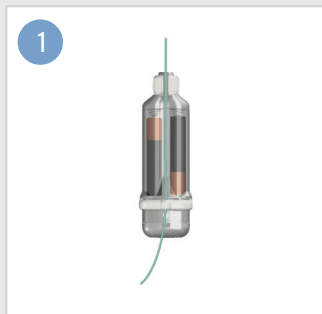

1 Feed the end of the line through the notch in the line clip and up through the groove in the locking collar.

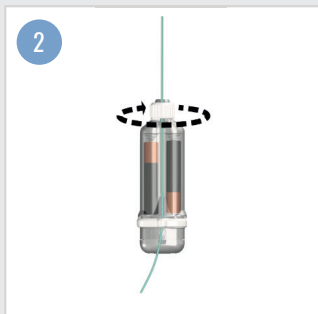

2 Twist the locking collar clockwise until it clicks, making sure the line trapped inside.

## Attaching using the optional snap / eye

For ProGlow snaps use with mono-filament lines between 1.2 mm - 3.0 mm in diameter.

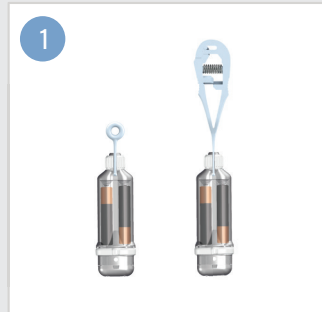

1 Place the end of the snap / eye into the groove in the locking collar.

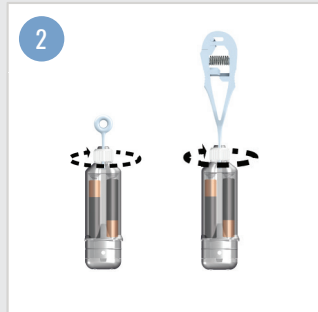

2 Twist the locking collar clockwise until it clicks, making sure the snap / eye is inside.



3 Squeeze the snap and attach it to the line.



+44 (0) 1803 849 311  
info@fishtekmarine.com  
www.fishtekmarine.com

Fishtek Marine, Unit 1, Webbers Way  
Dartington, Totnes, Devon, TQ9 6JY

## Technical specifications

Dimensions	92mm x 27mm x 16mm
Weight out of water	41 grams
In-water weight	17 grams
Depth Rating	1000m
Line attachment	1) Locking collar 2) ProGlow snap 3) ProGlow eye
Battery Type	2 replaceable AAA batteries
Immersion Switch	Automatic immersion switch
Housing	Durable polycarbonate
Colour Options	Green, blue, pink or white

## Proglow models

	Bright	Superbright	Ultrabright
Battery Life	5000 hours (3 Years fishing)	1700 hours (1 Year fishing)	500 hours (4 months fishing)
Light intensity	0.07 lumens (1x 4-inch lightstick)	0.21 lumens (3x 4-inch lightsticks)	0.70 lumens (9x 4-inch lightsticks)

## Battery replacement



1 Use a small flat head screwdriver and prise off the end cap



2 Replace old batteries with new batteries ensuring the polarity is correct



3 Click the endcap back onto the ProGlow. Test the light is working.